



DESIGNED FOR  
TODAY'S  
ARCHITECTURAL  
NEEDS

VITRIFIED CLAY WALL COPING



[SUPERIORCLAY.COM](http://SUPERIORCLAY.COM)



# VITRIFIED CLAY WALL COPING



CAMELBACK WALL COPING

DOUBLE SLANT WALL COPING

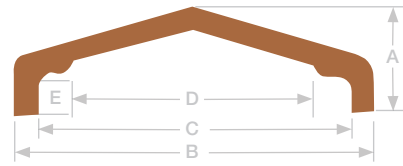
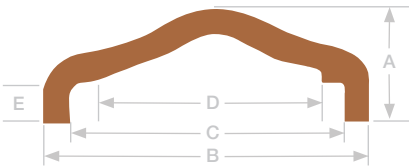
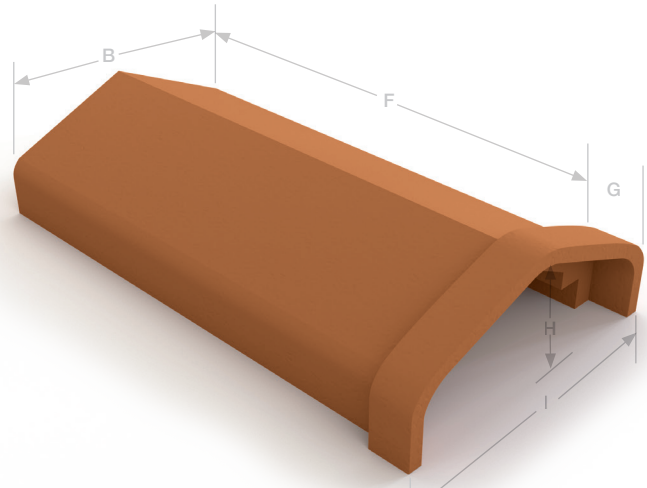
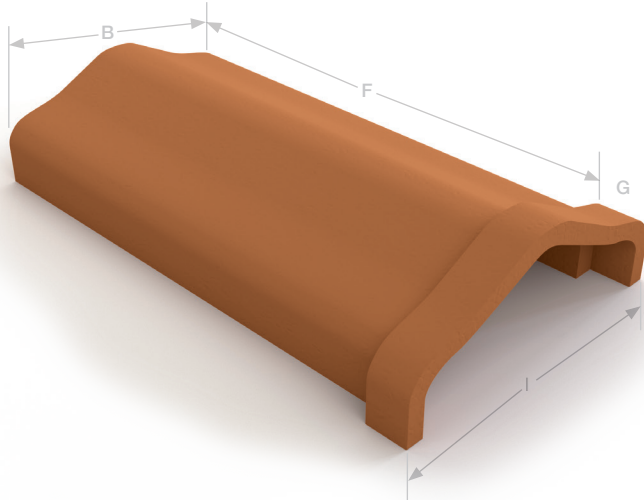

	9"	13"
A	3 <sup>3</sup> / <sub>4</sub> "	4 <sup>7</sup> / <sub>8</sub> "
B	11"	15 <sup>1</sup> / <sub>2</sub> "
C	9 <sup>1</sup> / <sub>2</sub> "	13 <sup>1</sup> / <sub>4</sub> "
D	7 <sup>1</sup> / <sub>2</sub> "	11 <sup>1</sup> / <sub>4</sub> "
E	2"	2 <sup>1</sup> / <sub>2</sub> "
F	24"	24"
G	2"	2"
H	4 <sup>1</sup> / <sub>2</sub> "	5 <sup>3</sup> / <sub>4</sub> "
I	13 <sup>1</sup> / <sub>8</sub> "	17 <sup>1</sup> / <sub>4</sub> "

	9"	13"	18"
A	3 <sup>5</sup> / <sub>8</sub> "	4"	6 <sup>1</sup> / <sub>4</sub> "
B	11 <sup>3</sup> / <sub>8</sub> "	16 <sup>3</sup> / <sub>8</sub> "	20 <sup>1</sup> / <sub>2</sub> "
C	9 <sup>3</sup> / <sub>4</sub> "	14 <sup>1</sup> / <sub>8</sub> "	18 <sup>1</sup> / <sub>2</sub> "
D	7 <sup>1</sup> / <sub>2</sub> "	11 <sup>3</sup> / <sub>4</sub> "	15"
E	1 <sup>1</sup> / <sub>2</sub> "	2"	1 <sup>3</sup> / <sub>4</sub> "
F	24"	24"	24"
G	2"	2 <sup>1</sup> / <sub>4</sub> "	2 <sup>1</sup> / <sub>4</sub> "
H	4 <sup>3</sup> / <sub>4</sub> "	5 <sup>1</sup> / <sub>2</sub> "	7 <sup>1</sup> / <sub>4</sub> "
I	13 <sup>1</sup> / <sub>2</sub> "	18 <sup>1</sup> / <sub>8</sub> "	23 <sup>1</sup> / <sub>4</sub> "

A COMPLETE LINE OF SUPERIOR CLAY FITTINGS ARE AVAILABLE AT

[SUPERIORCLAY.COM](http://SUPERIORCLAY.COM)



Superior Clay Wall Coping is available in straight sections as above or end, starter and corner sections as appear to the right. Superior Streamline Wall Coping features a tail insert that makes

a firm interlapping bond with the matching groove of the joining piece. Drop sides add a rigid structural strength and seal against the mortar to make a waterproof joint.



Superior Clay Vitrified Clay Wall Coping is durable which makes its hard surface impervious to the elements. It protects the mortar and top masonry material as well as the inside wall by keeping water from penetrating the top and running down the inside structure. Particularly important to the Architect or design engineer, the coefficient of the thermal expansion for Superior Clay Wall Coping is the same as other clay masonry wall units and closer to concrete masonry wall units than any other coping material. **Available in four distinctive styles in natural terra cotta or glazed.** Glazes include Classic Salt Glaze, or any of our standard glaze colors. We can also custom match glazes to meet the needs of any architectural style.



### STREAMLINE WALL COPING

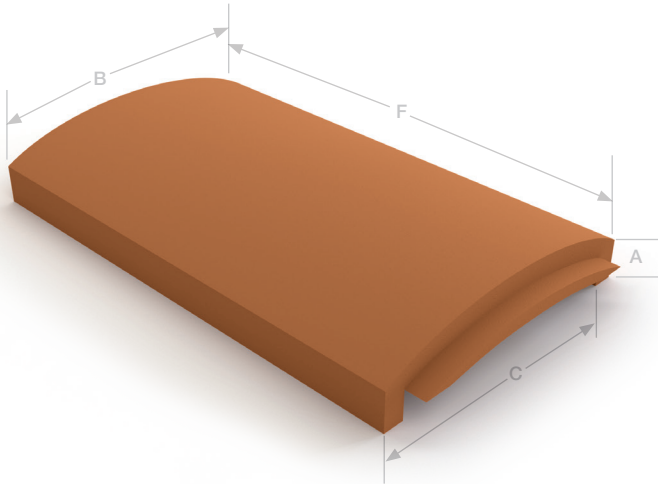

	9"	13"
A	3 <sup>5</sup> / <sub>8</sub> "	3 <sup>5</sup> / <sub>8</sub> "
B	11 <sup>1</sup> / <sub>4</sub> "	15 <sup>1</sup> / <sub>2</sub> "
C	9 <sup>1</sup> / <sub>4</sub> "	13 <sup>1</sup> / <sub>2</sub> "
D	5 <sup>3</sup> / <sub>4</sub> "	9 <sup>3</sup> / <sub>4</sub> "
E	1 <sup>1</sup> / <sub>8</sub> "	1"
F	24"	24"

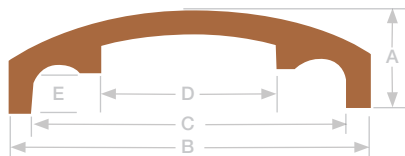

### SINGLE SLANT WALL COPING

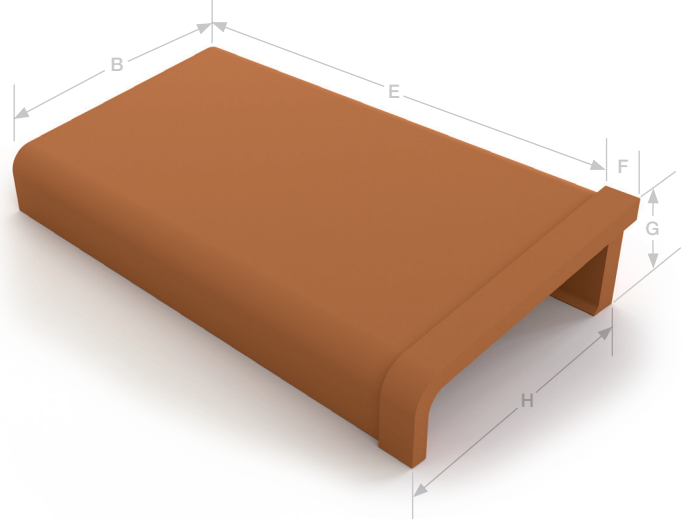

	9"	13"
A	3"	3 <sup>3</sup> / <sub>4</sub> "
B	9 <sup>3</sup> / <sub>4</sub> "	15 <sup>3</sup> / <sub>4</sub> "
C	8"	13 <sup>1</sup> / <sub>4</sub> "
D	1"	1 <sup>1</sup> / <sub>2</sub> "
E	24"	24"
F	1 <sup>3</sup> / <sub>4</sub> "	2"
G	4 <sup>1</sup> / <sub>8</sub> "	5"
H	11 <sup>1</sup> / <sub>4</sub> "	17"

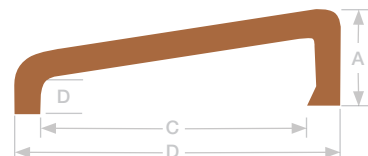

## RECOMMENDED SPECIFICATIONS – ORDERING INFORMATION AND INSTALLATION PROCEDURES



#### VITRIFIED CLAY WALL COPING

- Vitrified Clay Wall Coping shall be sound, standard weight, with flush joints in the styles as made by Superior Clay.
- All square corners and tee sections shall be factory or field cut.
- Use end sections where required.

#### FIELD CUTTING

As in most masonry work, field cutting is needed to meet requirements of the job. The straight sections of wall coping are shipped in joined pairs and must be separated. The two joined sections are pre-scored and require that they be separated by the use of a mallet and brick set chisel. Carefully tap along the scores using the tools required until the sections are cleanly separated.

#### FLASHING

- Use any approved PVC or polyethylene or other adequate flashing material as recommended by flashing manufacturer.

#### CAULKING

- Use any approved polysulfide, acrylic or silicone caulking compound as recommended by the manufacturer.

#### ORDERING INFORMATION

When ordering wall coping specify by the number of linear feet needed, the width of the coping, the number of right hand and left hand corners, as well as the starters and ends required.



## COMPLEMENT YOUR WALL COPING WITH ARCHITECTURAL TERRA-COTTA

**Architectural Terra-cotta** is, both in its structural and decorative form, unlimited in its ability to be formed to almost any shape, color or texture that the mind can conceive. Terra-cotta can be an economical alternative to stone and beings a unique medium, many effects can be obtained that cannot be achieved with stone or other building materials.



[SUPERIORCLAY.COM](http://SUPERIORCLAY.COM)



P.O. Box 352 • Uhrichsville, OH 44683

800-848-6166

Superior Clay occupies a 65-acre site in Tuscarawas Valley in Uhrichsville, Ohio. We have been manufacturing clay products for architects and builders for over fifty years. Superior Clay has the knowledge, the craftsmen and the facility to produce the highest quality architectural terra-cotta in any quantity.